



# CONVEYOR COMPONENTS

Moody have been appointed as a uni-chain distributor, and are able to offer the full range of uni-chain products.

Chains are available in a variety of widths and materials and the belts also come in various pitches and materials.

## Slat Top Chains - Steel

Straight Running

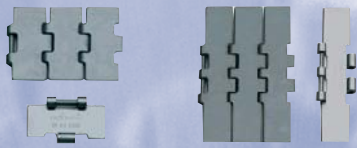

uni 810/812/815

uni 800/802/805

Side Flexing



uni 881

uni 881 TAB



uni Magnet Type

uni 881 Super Flex



uni 881

uni 881 TAB

uni 881 Super Flex

## Slat Top Chains - Plastic

Straight Running

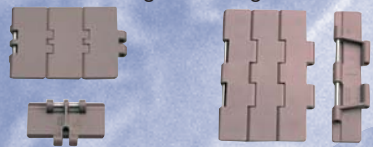

uni 820/831

uni 821

Side Flexing



uni 879/879 TAB

uni 880/880 TAB



uni 880 TAB-RT

uni 880 Super Flex

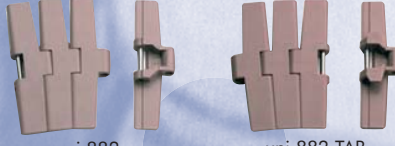

uni 882

uni 882 TAB



uni-chains  
Conveyor Chains



uni-chains  
Belt Systems



## Plastic Chains

Plastic chains are available in straight running and side flexing versions. Standard material for our plastic chains is acetal which is made in 3 different grades: D - acetal polymers with self-lubricating components; LF - acetal polymers with improved self-lubricating components; SLF - acetal polymers with self-lubricating additives to obtain the lowest possible friction resistance. uni-chains also produces plastic chains in other materials for use under special conditions.

Types Available:

Straight Running: uni 820/831 & uni 821.

Side Flexing: uni 879 / 879 TAB, uni 880/880 TAB,  
uni 880 TAB-RT, uni 880 Superflex, uni 882 & uni 882 TAB

## Steel Chains

uni-chains supplies slat top chains in straight running and side-flexing versions, with and without tabs. Magnet types are also available. uni-chains steel chains are made of steel alloys substantiated by certificates in the following 3 grades: Austenitic stainless steel, Ferritic stainless steel and Special hardened steel.

Types Available:

Straight Running: uni 810/812/815, uni 800/802/805.

Side Flexing: uni 881, uni 881 TAB, uni magnet type, uni 881 Superflex,  
uni 881, uni 881 TAB, uni 881 Superflex,

**All chains are available in a variety of widths and materials.**

## Belt Systems

uni-chains manufacture both straight and side flexing belt systems, with side flexing uni Flex-SNB being very popular. The belt systems are produced in several versions from closed to 36% open and with or without ribs. The pitches range between 12.7 and 50 mm.

Types Available: uni M-SNB, UNI Light, uni CNB, uni SNB, uni SNB M2, uni Light EP,  
uni SSB, uni OPB, uni L-SNB, uni MPB, uni Flex Belt, Reinforced Belts.

**All Belts are available in a variety of pitches and materials.**