



Delta UF3(A) & UFR3(A) Relief Valves

The following seal materials are available (fill in last two digits of ref.-no.)

*material seals:

- ../13-Silicone
- ../33-HNBR
- ../73-Viton
- ../93-EPDM

For Silicone take the HNBR-housing seal.

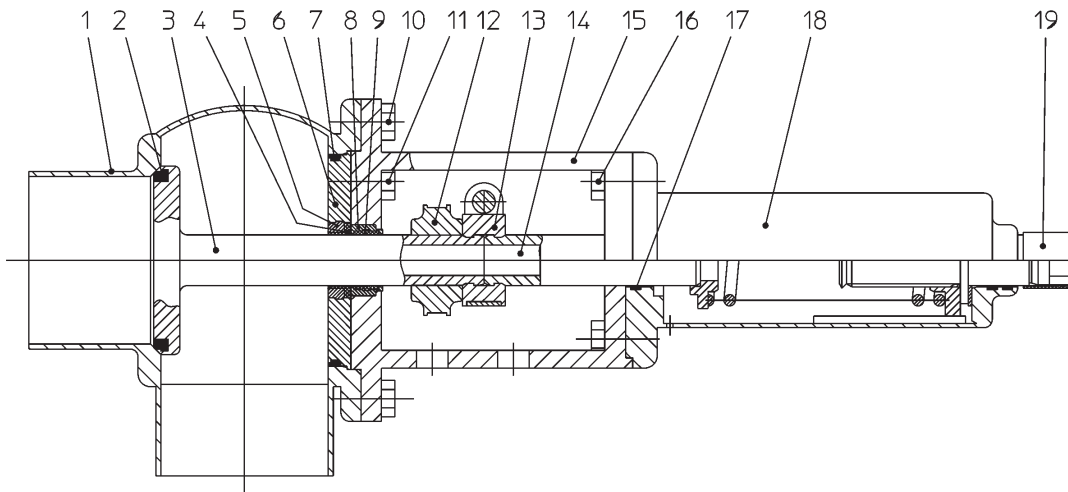

| | | | | DELTA UF31 RELIEF VALVE SPRING LOADED 1-4 TUBE | | | | | |
|-----|-----|---|----------|--|--------------------|--------------------|--------------------|--------------|--------------|
| | | | | 1T | 1.5T | 2T | 2.5T | 3T | 4T |
| Pos | Qty | Description | | Part Number | | | | | |
| 1 | 1 | Housing 1+2S | * | 15-41-324/47 | 15-41-424/47 | 15-41-474/47 | 15-41-524/47 | 15-41-551/47 | 15-41-674/47 |
| 2 | 1 | Seat Seal | * | 58-33-293/ | 58-33-393/ | 58-33-443/ | 58-33-493/ | 58-33-568/ | 58-33-643/ |
| 3 | 1 | Shaft | | 15-22-317/46 | 15-22-417/46 | 15-22-467/46 | 15-22-517/46 | 15-22-559/46 | 15-22-667/46 |
| 4 | 1 | Seal SW4 | | 58-33-150/26 | 58-33-150/26 | 58-33-150/26 | 58-33-150/26 | 58-33-150/26 | 58-33-150/26 |
| 5 | 1 | Seat Seal | * | 58-33-293/ | 58-33-293/ | 58-33-293/ | 58-33-293/ | 58-33-293/ | 58-33-293/ |
| 6 | 1 | Housing Cover | | 15-00-065/42 | 15-00-069/42 | 15-00-793/42 | 15-00-794/42 | 15-00-799/42 | 15-00-798/42 |
| 7 | 1 | Housing Seal | * | 58-33-292/ | 58-33-392/ | 58-33-442/ | 58-33-492/ | 58-33-567/ | 58-33-642/ |
| 8 | 1 | Bushing | | 08-01-181/12 | 08-01-181/12 | 08-01-181/12 | 08-01-179/12 | 08-01-179/12 | 08-01-179/12 |
| 9 | 1 | Bushing | | 08-01-178/93 | 08-01-178/93 | 08-01-178/93 | 08-01-178/93 | 08-01-178/93 | 08-01-178/93 |
| 10 | 4 | Hex. Screw | | 65-01-081/15 | 65-01-081/15 | 65-01-081/15 | 65-01-081/15 | 65-01-081/15 | 65-01-130/15 |
| 11 | 1 | Hex. Screw | | 65-01-056/13 | 65-01-081/15 | 65-01-081/15 | 65-01-081/15 | 65-01-081/15 | 65-01-081/15 |
| 12 | 1 | Operating Cam | | 08-60-082/12 | 08-60-082/12 | 08-52-135/92 | 08-52-135/92 | 08-52-135/92 | 08-52-135/92 |
| 13 | 1 | Coupling | | 08-52-110/13 | 08-52-110/13 | 08-52-110/13 | 08-52-110/13 | 08-52-110/13 | 08-52-110/13 |
| 14 | 1 | Intermediate Piece | | 09-87-084/42 | 09-87-084/42 | 09-87-085/42 | 09-87-085/42 | 09-87-085/42 | 09-87-085/42 |
| 15 | 1 | Yoke | | 16-40-091/17 | 16-40-385/17 | 16-40-435/17 | 16-40-485/17 | 16-40-560/17 | 16-40-635/17 |
| 16 | 4 | Hex. Screw | | 65-01-079/15 | 65-01-079/15 | 65-01-079/15 | 65-01-079/15 | 65-01-079/15 | 65-01-079/15 |
| 17 | 1 | PTFE Driving Band | | 08-39-079/93 | 08-39-079/93 | 08-39-079/93 | 08-39-079/93 | 08-39-079/93 | 08-39-079/93 |
| 18 | 1 | Relief Actuator (Depending on Pressure Range Required) | | Nr.31 16-30-170/17 | Nr.32 16-30-171/17 | Nr.33 16-30-172/17 | Nr.34 16-30-173/17 | | |
| 19 | 1 | Cap | | 08-60-006/93 | 08-60-006/93 | 08-60-006/93 | 08-60-006/93 | 08-60-006/93 | 08-60-006/93 |
| | 1 | Seal Kit | Viton | 58-34-438/00 | 58-34-439/00 | 58-34-440/00 | 58-34-441/00 | 58-34-443/00 | 58-34-444/00 |
| | 1 | Seal Kit | EPDM | 58-34-438/01 | 58-34-439/01 | 58-34-440/01 | 58-34-441/01 | 58-34-443/01 | 58-34-444/01 |
| | 1 | Seal Kit | Silicone | 58-34-438/02 | 58-34-439/02 | 58-34-440/02 | 58-34-441/02 | 58-34-443/02 | 58-34-444/02 |
| | 1 | Seal Kit | HNBR | 58-34-438/06 | 58-34-439/06 | 58-34-440/06 | 58-34-441/06 | 58-34-443/06 | 58-34-444/06 |

APV Delta UF3(A) & UFR3(A) Relief Valves (contd)

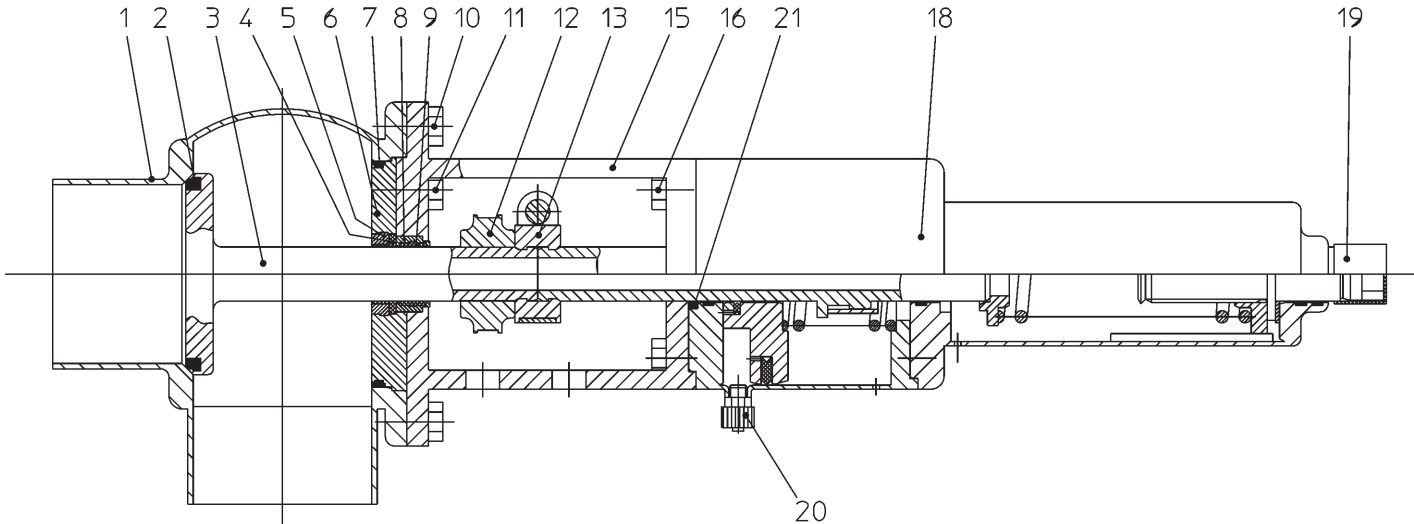

The following seal materials are available (fill in last two digits of ref.-no.)

- * material seals:
- ../13-Silicone
- ../33-HNBR
- ../73-Viton
- ../93-EPDM

For Silicone take the HNBR-housing seal.



| | | DELTA UF31-A RELIEF VALVE SPRING LOADED WITH CYLINDER FOR CLEANING 1-4 TUBE | | | | | | | |
|---|-----|---|--|-----------------------|-----------------------|-----------------------|-----------------------|---------------|---------------|
| | | | | 1T | 1.5T | 2T | 2.5T | 3T | 4T |
| Pos | Qty | Description | | Part Number | | | | | |
| 1 | 1 | Housing S21 1+2S | | 15-41-324/47 | 15-41-424/47 | 15-41-474/47 | 15-41-524/47 | 15-41-551/47 | 15-41-674/47 |
| 2 | 1 | Seat Seal * | | 58-33-293/ | 58-33-393/ | 58-33-443/ | 58-33-493/ | 58-33-568/ | 58-33-643/ |
| 3 | 1 | Shaft | | 15-22-317/46 | 15-22-417/46 | 15-22-467/46 | 15-22-517/46 | 15-22-559/46 | 15-22-667/46 |
| 4 | 1 | Seal SW4 | | 58-33-150/26 | 58-33-150/26 | 58-33-150/26 | 58-33-150/26 | 58-33-150/26 | 58-33-150/26 |
| 5 | 1 | Seat Seal * | | 58-33-293/ | 58-33-293/ | 58-33-293/ | 58-33-293/ | 58-33-293/ | 58-33-293/ |
| 6 | 1 | Housing Cover | | 15-00-065/42 | 15-00-069/42 | 15-00-793/42 | 15-00-794/42 | 15-00-799/42 | 15-00-798/42 |
| 7 | 1 | Housing Seal * | | 58-33-292/ | 58-33-392/ | 58-33-442/ | 58-33-492/ | 58-33-567/ | 58-33-642/ |
| 8 | 1 | Bushing | | 08-01-181/12 | 08-01-181/12 | 08-01-181/12 | 08-01-179/12 | 08-01-179/12 | 08-01-179/12 |
| 9 | 1 | Bushing | | 08-01-178/93 | 08-01-178/93 | 08-01-178/93 | 08-01-178/93 | 08-01-178/93 | 08-01-178/93 |
| 10 | 4 | Hex. Screw | | 65-01-081/15 | 65-01-081/15 | 65-01-081/15 | 65-01-081/15 | 65-01-081/15 | 65-01-130/15 |
| 11 | 1 | Hex. Screw | | 65-01-056/13 | 65-01-081/15 | 65-01-081/15 | 65-01-081/15 | 65-01-081/15 | 65-01-081/15 |
| 12 | 1 | Operating Cam | | 08-60-082/12 | 08-60-082/12 | 08-52-135/92 | 08-52-135/92 | 08-52-135/92 | 08-52-135/92 |
| 13 | 1 | Coupling | | 08-52-110/113 | 08-52-110/113 | 08-52-110/113 | 08-52-110/113 | 08-52-110/113 | 08-52-110/113 |
| 15 | 1 | Yoke | | 16-40-091/17 | 16-40-385/17 | 16-40-435/17 | 16-40-485/17 | 16-40-560/17 | 16-40-635/17 |
| 16 | 4 | Hex. Screw | | 65-01-079/15 | 65-01-079/15 | 65-01-079/15 | 65-01-079/15 | 65-01-079/15 | 65-01-079/15 |
| 18 | 1 | Spring Actuator with Cylinder for Cleaning | | Nr.31-12 16-30-180/17 | Nr.32-12 16-30-182/17 | Nr.33-12 16-30-184/17 | Nr.34-25 16-30-186/17 | | |
| (Depending on Pressure Range Required Use Corresponding Spring Actuator with Cylinder for Cleaning) | | | | Nr.31-25 16-30-181/17 | Nr.32-25 16-30-183/17 | Nr.33-25 16-30-185/17 | | | |
| 19 | 1 | Cap | | 08-60-006/93 | 08-60-006/93 | 08-60-006/93 | 08-60-006/93 | 08-60-006/93 | 08-60-006/93 |
| 20 | 1 | Air Union | | 08-63-010/93 | 08-63-010/93 | 08-63-010/93 | 08-63-010/93 | 08-63-010/93 | 08-63-010/93 |
| 21 | 1 | O-Ring | | 58-06-078/83 | 58-06-078/83 | 58-06-078/83 | 58-06-078/83 | 58-06-078/83 | 58-06-078/83 |
| | 1 | Seal Kit Viton | | 58-34-438/00 | 58-34-439/00 | 58-34-440/00 | 58-34-441/00 | 58-34-443/00 | 58-34-444/00 |
| | 1 | Seal Kit EPDM | | 58-34-438/01 | 58-34-439/01 | 58-34-440/01 | 58-34-441/01 | 58-34-443/01 | 58-34-444/01 |
| | 1 | Seal Kit Silicone | | 58-34-438/02 | 58-34-439/02 | 58-34-440/02 | 58-34-441/02 | 58-34-443/02 | 58-34-444/02 |
| | 1 | Seal Kit HNBR | | 58-34-438/06 | 58-34-439/06 | 58-34-440/06 | 58-34-441/06 | 58-34-443/06 | 58-34-444/06 |



Delta UF3(A) & UFR3(A) Relief Valves (contd)

The following seal materials are available (fill in last two digits of ref.-no.)

*material seals:

- ../13-Silicone
- ../33-HNBR
- ../73-Viton
- ../93-EPDM

For Silicone take the HNBR-housing seal.

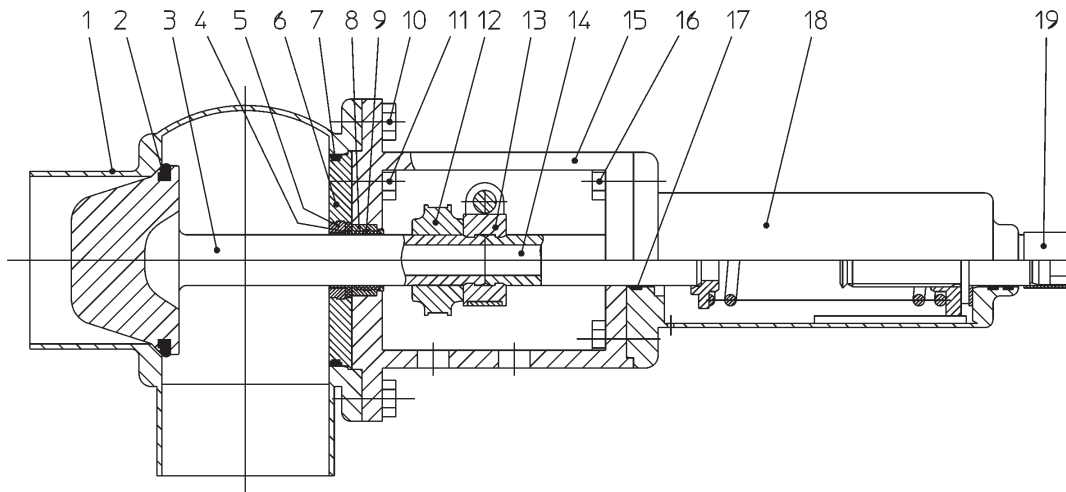

DELTA UFR31 RELIEF VALVE SPRING LOADED WITH THROTTLING CONE 1-4 TUBE

| Pos | Qty | Description | Part Number | | | | | |
|-----|-----|---|--------------------|--------------------|--------------------|--------------------|--------------|--------------|
| | | | 1T | 1.5T | 2T | 2.5T | 3T | 4T |
| 1 | 1 | Housing S21 1+2S | 15-41-324/47 | 15-41-424/47 | 15-41-474/47 | 15-41-524/47 | 15-41-551/47 | 15-41-674/47 |
| 2 | 1 | Seat Seal * | 58-33-294/ | 58-33-394/ | 58-33-444/ | 58-33-494/ | 58-33-569/ | 58-33-644/ |
| 3 | 1 | Shaft | 15-22-171/42 | 15-22-164/42 | 15-22-165/42 | 15-22-166/42 | 15-22-154/42 | 15-22-218/42 |
| 4 | 1 | Seal SW4 | 58-33-150/26 | 58-33-150/26 | 58-33-150/26 | 58-33-150/26 | 58-33-150/26 | 58-33-150/26 |
| 5 | 1 | Seat Seal * | 58-33-293/ | 58-33-293/ | 58-33-293/ | 58-33-293/ | 58-33-293/ | 58-33-293/ |
| 6 | 1 | Housing Cover | 15-00-065/42 | 15-00-069/42 | 15-00-793/42 | 15-00-794/42 | 15-00-799/42 | 15-00-798/42 |
| 7 | 1 | Housing Seal * | 58-33-292/ | 58-33-392/ | 58-33-442/ | 58-33-492/ | 58-33-567/ | 58-33-642/ |
| 8 | 1 | Bushing | 08-01-181/12 | 08-01-181/12 | 08-01-181/12 | 08-01-179/12 | 08-01-179/12 | 08-01-179/12 |
| 9 | 1 | Bushing | 08-01-178/93 | 08-01-178/93 | 08-01-178/93 | 08-01-178/93 | 08-01-178/93 | 08-01-178/93 |
| 10 | 4 | Hex. Screw | 65-01-081/15 | 65-01-081/15 | 65-01-081/15 | 65-01-081/15 | 65-01-081/15 | 65-01-130/15 |
| 11 | 1 | Hex. Screw | 65-01-056/13 | 65-01-081/15 | 65-01-081/15 | 65-01-081/15 | 65-01-081/15 | 65-01-081/15 |
| 12 | 1 | Operating Cam | 08-60-082/12 | 08-60-082/12 | 08-52-135/92 | 08-52-135/92 | 08-52-135/92 | 08-52-135/92 |
| 13 | 1 | Coupling | 08-52-110/13 | 08-52-110/13 | 08-52-110/13 | 08-52-110/13 | 08-52-110/13 | 08-52-110/13 |
| 14 | 1 | Intermediate Piece | 09-87-084/42 | 09-87-084/42 | 09-87-085/42 | 09-87-085/42 | 09-87-085/42 | 09-87-085/42 |
| 15 | 1 | Yoke | 16-40-091/17 | 16-40-385/17 | 16-40-435/17 | 16-40-485/17 | 16-40-560/17 | 16-40-635/17 |
| 16 | 4 | Hex. Screw | 65-01-079/15 | 65-01-079/15 | 65-01-079/15 | 65-01-079/15 | 65-01-079/15 | 65-01-079/15 |
| 17 | 1 | PTFE Driving Band | 08-39-079/93 | 08-39-079/93 | 08-39-079/93 | 08-39-079/93 | 08-39-079/93 | 08-39-079/93 |
| 18 | 1 | Relief Actuator (Depending on Pressure Range Required) | Nr.31 16-30-170/17 | Nr.32 16-30-171/17 | Nr.33 16-30-172/17 | Nr.34 16-30-173/17 | | |
| 19 | 1 | Cap | 08-60-006/93 | 08-60-006/93 | 08-60-006/93 | 08-60-006/93 | 08-60-006/93 | 08-60-006/93 |
| | 1 | Seal Kit Viton | 58-34-450/00 | 58-34-451/00 | 58-34-452/00 | 58-34-453/00 | 58-34-455/00 | 58-34-456/00 |
| | 1 | Seal Kit EPDM | 58-34-450/01 | 58-34-451/01 | 58-34-452/01 | 58-34-453/01 | 58-34-455/01 | 58-34-456/01 |
| | 1 | Seal Kit Silicone | 58-34-450/02 | 58-34-451/02 | 58-34-452/02 | 58-34-453/02 | 58-34-455/02 | 58-34-456/02 |
| | 1 | Seal Kit HNBR | 58-34-450/06 | 58-34-451/06 | 58-34-452/06 | 58-34-453/06 | 58-34-455/06 | 58-34-456/06 |

APV Delta UF3(A) & UFR3(A) Relief Valves (contd)

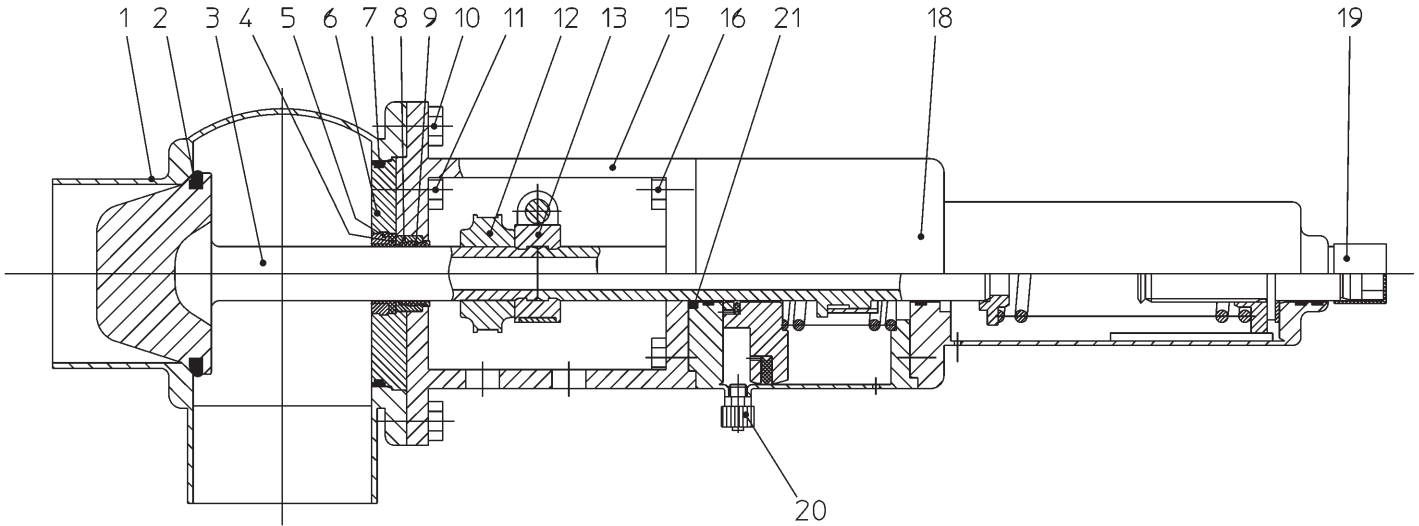

The following seal materials are available (fill in last two digits of ref.-no.)

- * material seals:
 ../13-Silicone
 ../33-HNBR
 ../73-Viton
 ../93-EPDM

For Silicone take the HNBR-housing seal.



DELTA UFR31-A RELIEF VALVE SPRING LOADED WITH THROTTLING CONE & CYLINDER FOR CLEANING 1-4 TUBE

| Pos | Qty | Description | Part Number | | | | | | |
|-----|-----|---|-----------------------|-----------------------|-----------------------|-----------------------|-----------------------|-----------------------|-----------------------|
| | | | 1T | 1.5T | 2T | 2.5T | 3T | 4T | |
| 1 | 1 | Housing S21 1+2S | 15-41-324/47 | 15-41-424/47 | 15-41-474/47 | 15-41-524/47 | 15-41-551/47 | 15-41-674/47 | |
| 2 | 1 | Seal Seal * | 58-33-294/ | 58-33-394/ | 58-33-444/ | 58-33-494/ | 58-33-569/ | 58-33-644/ | |
| 3 | 1 | Shaft | 15-22-171/42 | 15-22-164/42 | 15-22-165/42 | 15-22-166/42 | 15-22-154/42 | 15-22-218/42 | |
| 4 | 1 | Seal SW4 | 58-33-150/26 | 58-33-150/26 | 58-33-150/26 | 58-33-150/26 | 58-33-150/26 | 58-33-150/26 | |
| 5 | 1 | Seal Seal * | 58-33-293/ | 58-33-293/ | 58-33-293/ | 58-33-293/ | 58-33-293/ | 58-33-293/ | |
| 6 | 1 | Housing Cover | 15-00-065/42 | 15-00-069/42 | 15-00-793/42 | 15-00-794/42 | 15-00-799/42 | 15-00-798/42 | |
| 7 | 1 | Housing Seal * | 58-33-292/ | 58-33-392/ | 58-33-442/ | 58-33-492/ | 58-33-567/ | 58-33-642/ | |
| 8 | 1 | Bushing | 08-01-181/12 | 08-01-181/12 | 08-01-181/12 | 08-01-179/12 | 08-01-179/12 | 08-01-179/12 | |
| 9 | 1 | Bushing | 08-01-178/93 | 08-01-178/93 | 08-01-178/93 | 08-01-178/93 | 08-01-178/93 | 08-01-178/93 | |
| 10 | 4 | Hex. Screw | 65-01-081/15 | 65-01-081/15 | 65-01-081/15 | 65-01-081/15 | 65-01-081/15 | 65-01-130/15 | |
| 11 | 1 | Hex. Screw | 65-01-056/13 | 65-01-081/15 | 65-01-081/15 | 65-01-081/15 | 65-01-081/15 | 65-01-081/15 | |
| 12 | 1 | Operating Cam | 08-60-082/12 | 08-60-082/12 | 08-52-135/92 | 08-52-135/92 | 08-52-135/92 | 08-52-135/92 | |
| 13 | 1 | Coupling | 08-52-110/13 | 08-52-110/13 | 08-52-110/13 | 08-52-110/13 | 08-52-110/13 | 08-52-110/13 | |
| 15 | 1 | Yoke | 16-40-091/17 | 16-40-385/17 | 16-40-435/17 | 16-40-485/17 | 16-40-560/17 | 16-40-635/17 | |
| 16 | 4 | Hex. Screw | 65-01-079/15 | 65-01-079/15 | 65-01-079/15 | 65-01-079/15 | 65-01-079/15 | 65-01-079/15 | |
| 18 | 1 | Spring Actuator with Cylinder for Cleaning (Depending on Pressure Range Required Use Corresponding Spring Actuator with Cylinder for Cleaning) | Nr.31-12 16-30-180/17 | Nr.32-12 16-30-182/17 | Nr.33-12 16-30-184/17 | Nr.34-25 16-30-186/17 | Nr.31-25 16-30-181/17 | Nr.32-25 16-30-183/17 | Nr.33-25 16-30-185/17 |
| 19 | 1 | Cap | 08-60-006/93 | 08-60-006/93 | 08-60-006/93 | 08-60-006/93 | 08-60-006/93 | 08-60-006/93 | |
| 20 | 1 | Air Union | 08-63-010/93 | 08-63-010/93 | 08-63-010/93 | 08-63-010/93 | 08-63-010/93 | 08-63-010/93 | |
| 21 | 1 | O-Ring | 58-06-078/83 | 58-06-078/83 | 58-06-078/83 | 58-06-078/83 | 58-06-078/83 | 58-06-078/83 | |
| | 1 | Seal Kit Viton | 58-34-450/00 | 58-34-451/00 | 58-34-452/00 | 58-34-453/00 | 58-34-455/00 | 58-34-456/00 | |
| | 1 | Seal Kit EPDM | 58-34-450/01 | 58-34-451/01 | 58-34-452/01 | 58-34-453/01 | 58-34-455/01 | 58-34-456/01 | |
| | 1 | Seal Kit Silicone | 58-34-450/02 | 58-34-451/02 | 58-34-452/02 | 58-34-453/02 | 58-34-455/02 | 58-34-456/02 | |
| | 1 | Seal Kit HNBR | 58-34-450/06 | 58-34-451/06 | 58-34-452/06 | 58-34-453/06 | 58-34-455/06 | 58-34-456/06 | |